

Aug. 6, 1887

013122

PLAT OF

PUBLIC STREET

FROM PRAIRIE AVE. TO EDDY ST.

IN THREE SHEETS.

SCALE 50 FEET PER INCH.

Providence R.I.
This plat accompanies
our report of this date.

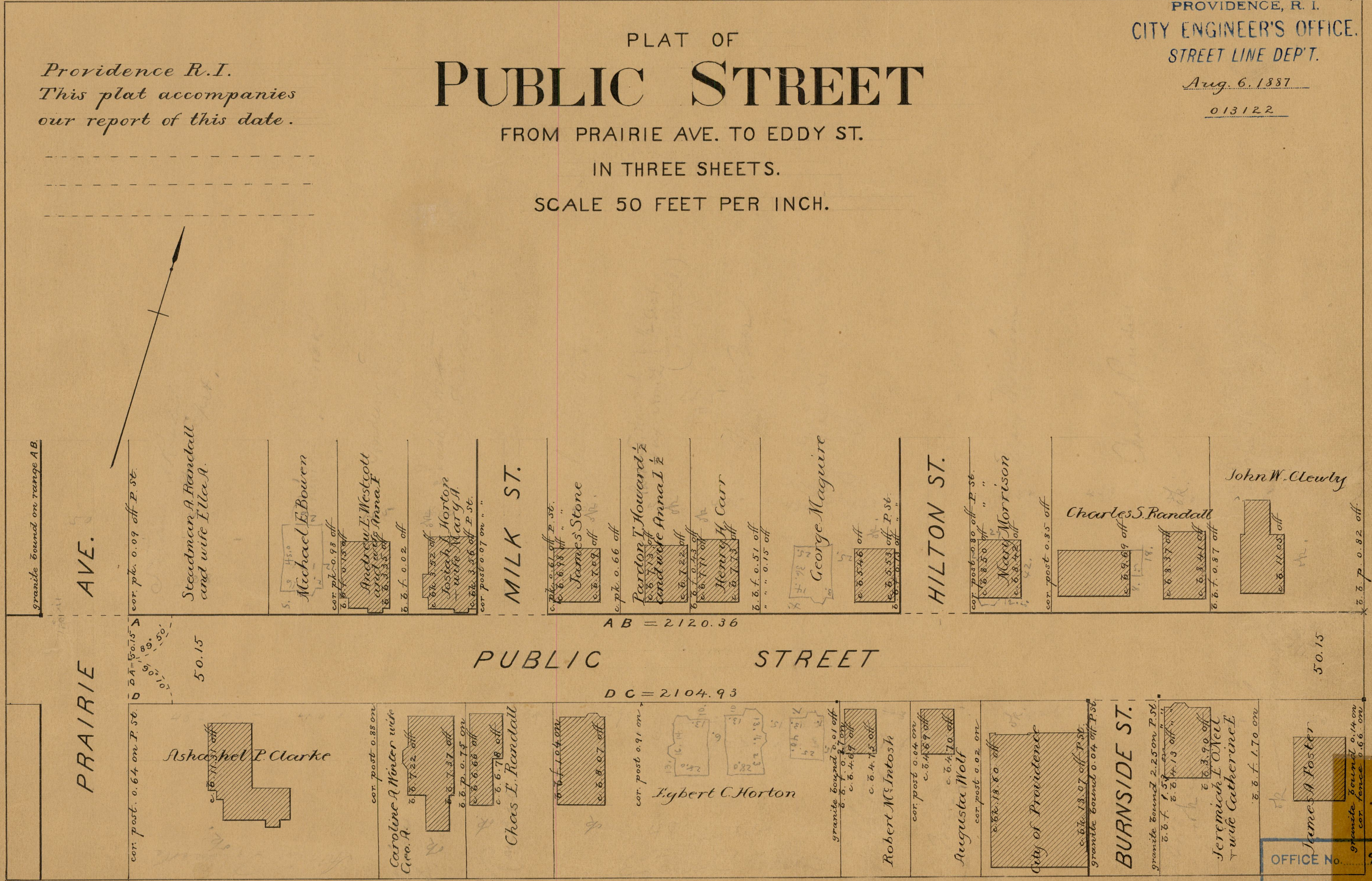

PRAIRIE AVE.

PRAIRIE

MILK ST.

HILTON ST.

BURNSIDE ST.

PUBLIC STREET

AB = 2120.36

DC = 2104.93

cor. post. 0.64 on P. St.

cor. pk. 0.09 off P. St.

Ashahel P. Clarke

Stedman A. Randall
and wife Ella A.

Michael E. Bowen

Caroline A. Winter wife
Geo. A.

Ames W. Westcott
and wife Anna I.

Chas. I. Randall

Foster A. Horton
wife Mary A.

Hybert C. Horton

James Stone

cor. post 0.91 on

Parson T. Howard
and wife Anna I.

Robert M. Intosh

Henry H. Carr

Augustus Wolf

George Maguire

City of Providence

Mary Morrison

granite bound 0.04 off P. St.

cor. post 0.95 off

Charles S. Randall

granite bound 2.25 on P. St.

Jeremiah I. O'Neil
wife Catherine I.

cor. post 0.82 off

John W. Clewley

OFFICE No. 9356
DRAWER 83
SHEET A-45

83
A-45